

Welcome to
Westhoughton High School



Westhoughton
HIGH SCHOOL



Westhoughton High School



How should you prepare for your first day?



We are proud to be part of Westhoughton High and hope that you will be too. We have high standards of presentation for everyone, so we expect you to look smart and come to school with all the equipment you will need.

Make sure you are wearing the correct uniform. You will also need a school bag which has room for all your books, equipment and packed lunch, if you have one.

It will help you settle in more easily and confidently if you know that you have everything you need when you arrive at school.

UNIFORM

- Navy blue school blazer, badged
- School tie with Gold stripe - Year 7 2025
- Plain white school shirt
- Navy blue V-necked jumper with school logo (*Optional item*)
- Mid-grey tailored school knee-length wide-pleated skirt must be worn with black opaque tights
- Mid-grey or black straight tailored school trousers or
- Mid-grey tailored school knee-length shorts
- Plain black sensible school shoes (not trainers)



School tie colours:

Gold stripe - Year 7

Green stripe - Year 8

Blue stripe - Year 9

Red stripe - Year 10

White stripe - Year 11



Do you know what the Westhoughton High school uniform is?

Do you know what you need to bring?

What happens when you arrive at school?





We know that it can be daunting starting at a new school. So, when you arrive the staff will be there to give you a warm welcome.

Staff will guide you to your form room. Here, you will meet your tutor every morning to check how you are. They will always be there to talk to first thing every day if you ever need help or advice. You will also have the opportunity to meet and talk with other students and make new friends.

The school days starts at 8.30am and finishes at 3.15pm
(2.15pm on Wednesdays)

On the first day you will receive free food at break and at lunchtime. Food and drink can be purchased at break and lunch with our cashless system through ParentPay, details for this will be sent to parents in the summer holidays.

Are you looking forward to coming to Westhoughton High?



What happens during the school day?

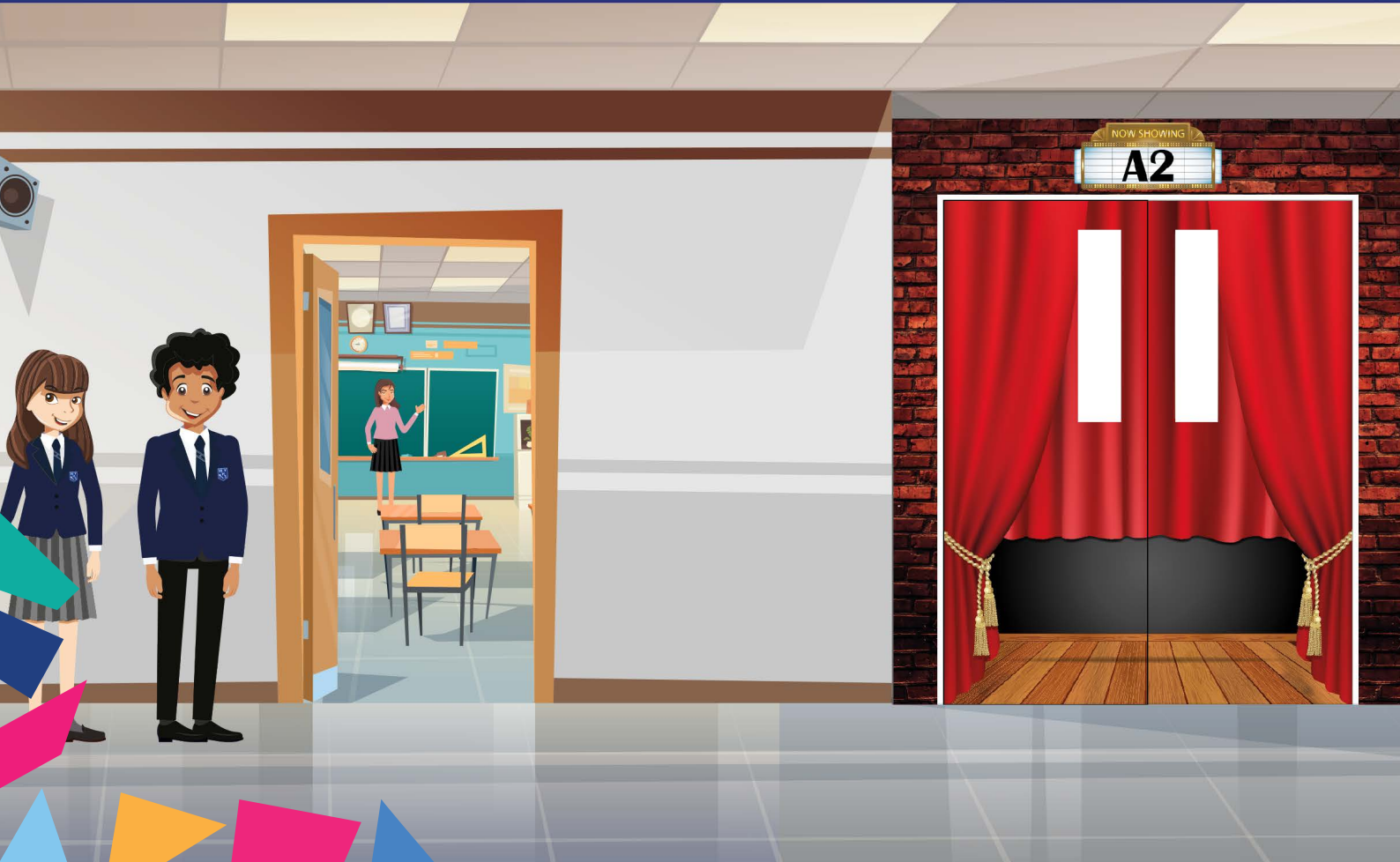



Every day, you will have five lessons (four lessons on Wednesdays). The day starts with form time which includes 20 minutes of form time reading. Each day has a morning break and lunchtime. You will go to different classes for your lessons so you will soon get to know your way around the school.

We have fantastic facilities and equipment for you to use, and there are lots of exciting new things for you to learn.

You will study subjects in more detail, and if you haven't already, you will discover subjects that you love.



What subjects do you like? Aim high with all your lessons.

Take a look at our school map to familiarise yourself with our school site, don't worry there are always lots of staff around who will direct you where you need to go.

Within a couple of days you will know where all your classrooms are.

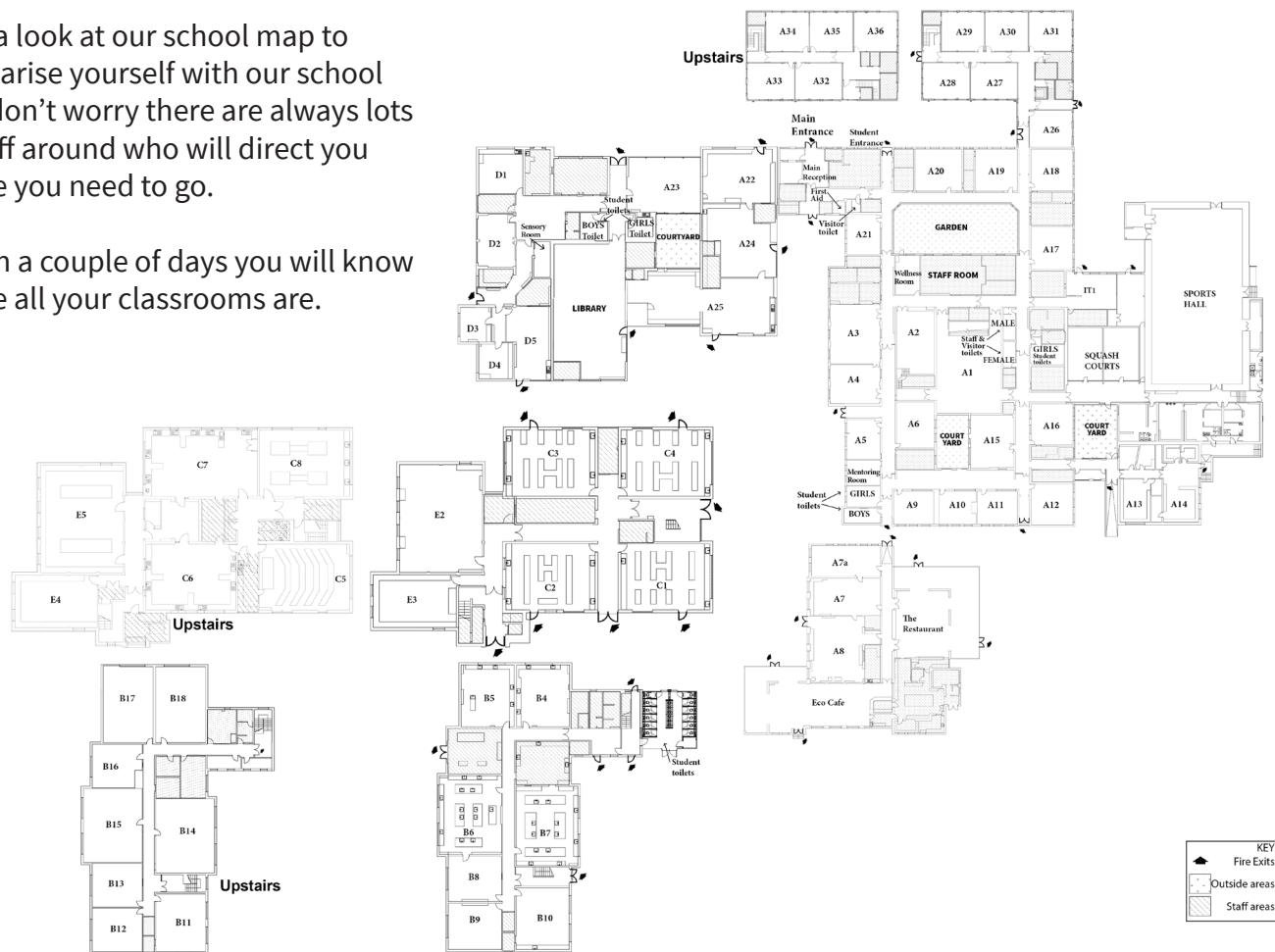



Good attendance at school is one of the most important factors in ensuring that children and young people have the maximum life chances.

Attendance is strongly linked to educational achievement. Children who miss school frequently can fall behind with their work and do less well in exams.



Keep your attendance on track

100% Attendance

Well Done!

- Our target for all students
- You are right on track

97% Attendance

Well Done, keep it up

- You are on the right track for success keep it up
- 6 Days Absence = 30 hours of lost learning

95% Attendance

We're Concerned

- Poor attendance gives you less chance of success
- 10 Days Absence = 50 hours of lost learning

90% Attendance

Seriously Worried

- Very poor attendance has a serious impact on your education
- 19 Days Absence = 95 hours of lost learning

What do we expect from you?



To keep Westhoughton High a fantastic school to attend, and a school that you can be proud to belong to we all **Learn**.

Every student is encouraged to develop and achieve according to their abilities, aptitudes and interests and our job is to challenge and support them.

Learning beyond the classroom is also very important to the development of the well-rounded individual whether it be through sport, musical tuition or one of our enterprising activities.



Look after each other • Enjoy our school • Aim high
Respect one another, ourselves & our school
Never stop learning

Learning is rewarded

At Westhoughton High we believe we are ALL learners and every opportunity should be taken to **Learn**. Learning is rewarded by our points scheme. Students are rewarded for learning well and excellent work. At the end of each half term if you have met the points target students are rewarded.

These can include: Special breakfasts, Free lunch, Hot chocolates, Ice creams, Rewards Trips and Vouchers.

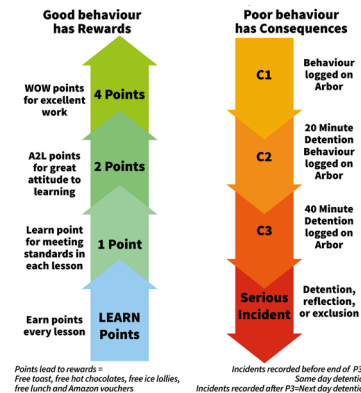

Make our Pledge



ABOUT BULLYING

I will trust my instincts and have the courage to be an upstander and help others.

Whether I am affected or not, I will stand up against all forms of bullying and hold my peers accountable.

I will treat everyone with respect - inclusive of gender, race, ethnicity, sexuality, size, disability, religion, age, class or other differences.

I recognize that my words, gestures, jokes and actions have the potential to create harm.

If I realize I have hurt someone, I will apologize and learn from my mistake.

I commit to be an upstander for an inclusive society for all and embrace the responsibility for the wellbeing of those around me.

Sign up
to our
Pledge





At Westhoughton High School we look after each other so we can all enjoy our school. However bullying can happen, as it does in all schools this is how you can report it:

You can talk to any member of staff, however specific people who are here to help are:

- Your form tutor
- Your Student Support Leader (SSL) - Ms Walsh
- Your Student Progress Leader (SPL) - Mr Barwise
- Assistant Headteacher KS3 – Mr Parkinson
- Assistant Headteacher KS4 – Mr Dignam

Scan this QR code, fill in the simple form to report any bullying anonymously. More details can be found on our school web page here:

www.westhoughton-high.org/together-against-bullying/

Look after each other



Educate:

- Help students to have their voices heard.
- Model kindness and compassion for all staff and students in WHS.
- Educate all staff and students on the dangers of stereotyping and stigmatising others.
- Deliver training to teach students how to regulate emotions and effectively communicate their feelings.

Enjoy:

- Make WHS a kinder, more caring, and more compassionate place to work.
- Create a positive atmosphere that all staff, students, and visitors can enjoy.
- Spread our positivity to the local community.

Empower:

- Increase self-confidence for all students; confident students can stand up for themselves and confident students do not bully.
- Develop systems that enable faster and more efficient ways to deal with bullying.
- Promote and celebrate individual identities to enable students to feel comfortable in their own skin.

See it, Report it,
Anonymous Incident log here:



In the world where you can be anything, be kind.



What other activities can you take part in?





Outside of the normal lessons, there are opportunities to join clubs at lunchtime or after school. You can even start your own if you have a real passion to share your hobbies and interests.

You will visit colleges and universities and go on trips around the UK and beyond to develop your character and give you the best possible start in life.

We hope you enjoy your time at Westhoughton High and we can't wait for you to arrive.



What are your hobbies?



Westhoughton

HIGH SCHOOL

Westhoughton High School
Bolton Road
Westhoughton
Bolton
BL5 3DN

Tel: 01942 814 122

Email: whsoffice@westhoughton-high.org

www.westhoughton-high.org

